

WEEBL-8.0-KIT-SS
RAIL GROUNDING LUG
w/ SS HARDWARE

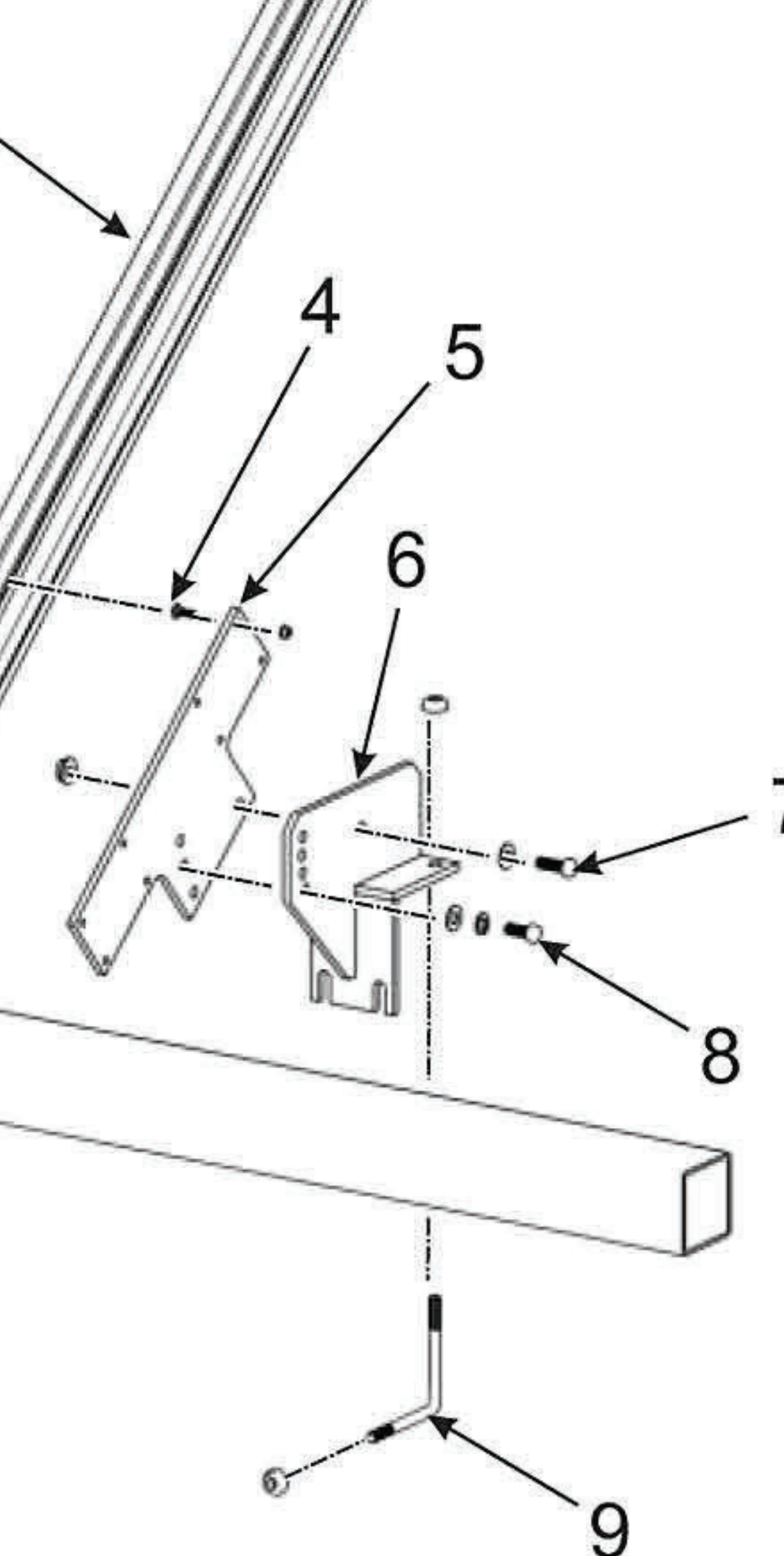
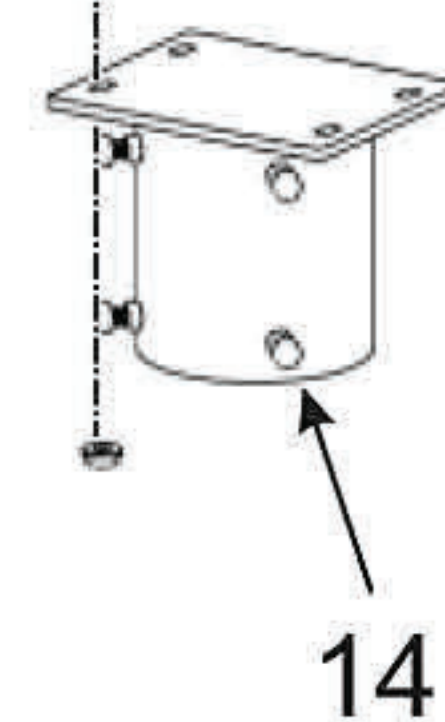
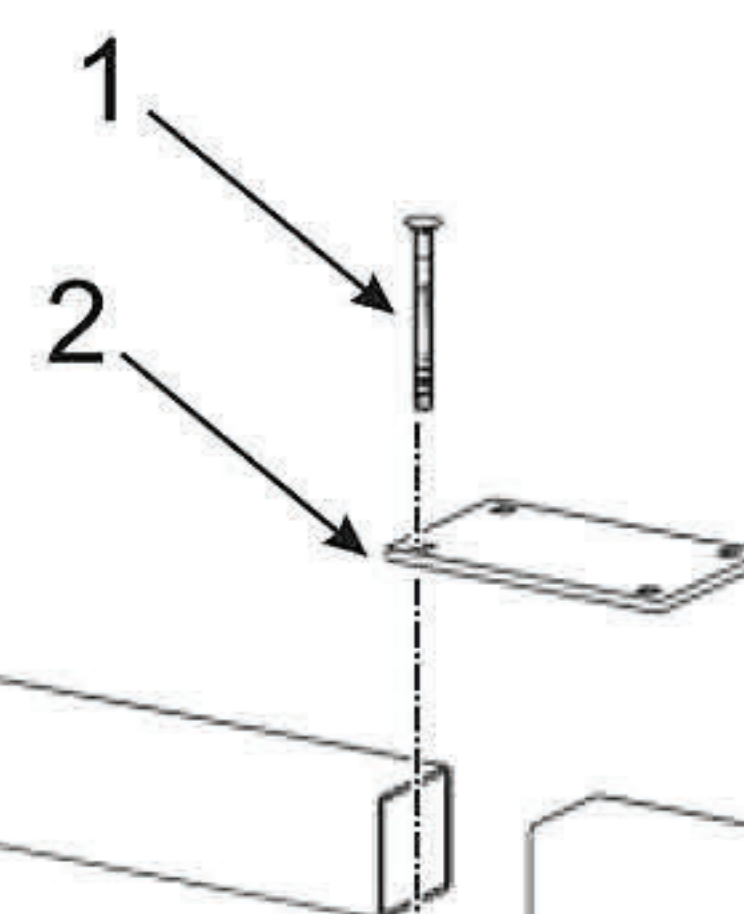
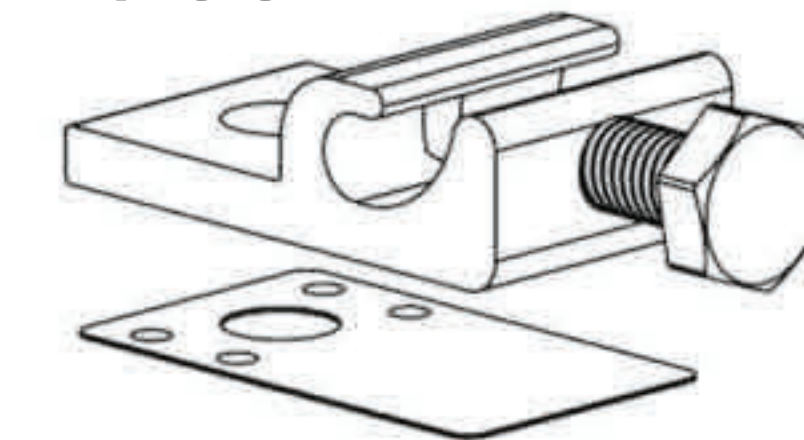

Item	Description	Qty
1	Carriage Bolt (1/2" x 6" or 1/2" x 7"), flange nut	4 per Pipe Cap
2	Top Plate	1 per Vertical Pipe
3	P14 Power Rail	2 per Rail Set
4	Carriage Bolt (5/16" x 1"), flange nut	16 per Rail Set
5	Rail Bracket	2 per Rail Set
6	Strongback Bracket (for 4" x 4" or 5" x 4")	2 per Rail Set
7	Pivot Bolt (1/2" x 1-1/2"), flat washer, flange nut	2 per Rail Set
8	Lock Bolt (1/2" x 1-1/4"), lock & flat washer	2 per Rail Set
9	L-Bolt (1/2" x 5-1/2" x 5-1/2 or 1/2" x 5-1/2" x 6-1/2"), flange nuts	4 per Rail Set
10	End Clamp, (5/16" x *) carriage bolt, flange nut	4 per Rail Set
11	Mid Clamp, (5/16" x *) carriage bolt, flange nut	2 per 3/8" gap between modules
12	RAD End-Clamp, (5/16" x *) bolt, flange nut	4 per Rail Set
13	RAD Mid-Clamp, (5/16" x *) bolt, flange nut	2 per 3/8" gap between modules
14	Pipe Cap	1 per Vertical Pipe

* 2", 2-1/4", 2-1/2", or 2-3/4" bolt. Length is dependent on depth of PV Module frame

Notes: 1. Option to install Mid Clamp with carriage bolt or use RAD bolt with RAD Mid Clamp.
2. Option to install End Clamp with carriage bolt or use RAD bolt with RAD End Clamp.

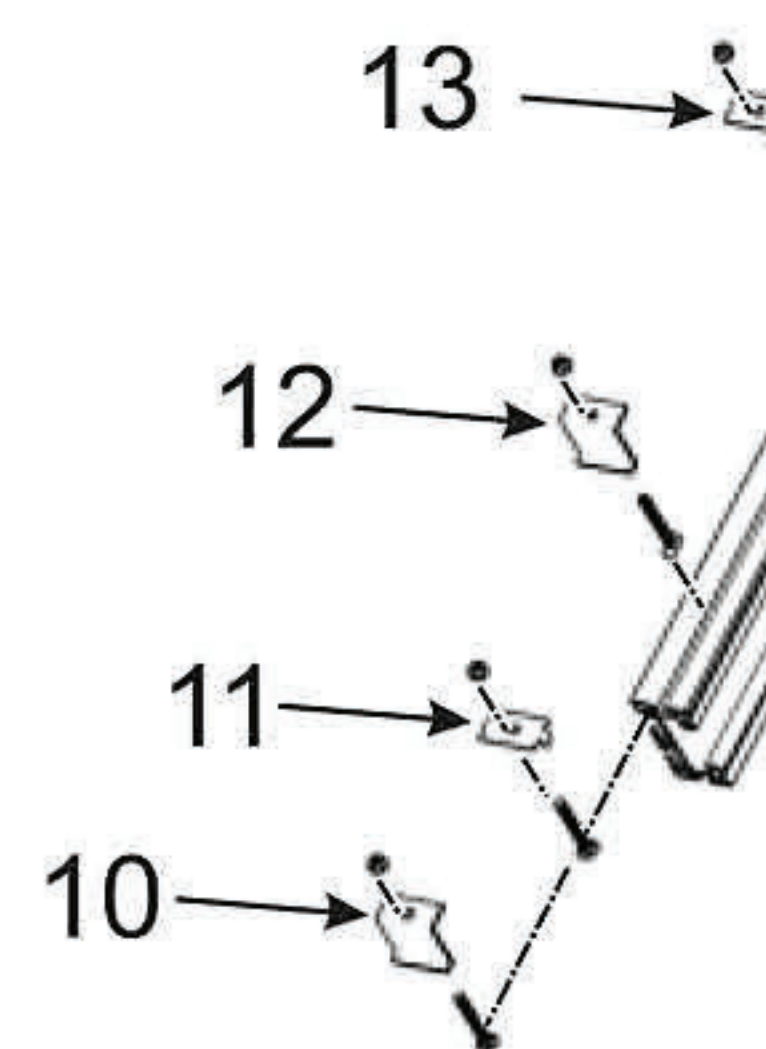

Sample for 24 Panel Installation.
Installer to supply:
 (6) vertical pipes -6" Sch 40 - approximately 161" long
 (3) horizontal mid-tube(s) -4"x4"x.188 - approximately 66" long
 (2) horizontal end-tube(s) - 4"x4"x.188 - approximately 96" long
 (6) Concrete Foundations: Approx. 64 in. deep x 36 in dia.
 with East/West spacing approx. 66 in. on center
Exclusions:
 Freight/Shipping
 Professional Engineer's stamp and calculations
 Wire management (clips, ties, etc...)
 Concrete foundations