

# BYD P6-30 Series



BYD has developed a line of PV cells with increased energy efficiency without increasing cell manufacturing costs. If you have special requirements, we can design accordingly.

## Features

- High efficiency
- Excellent optical performance
- Steady output voltage in direct current
- Easy to be installed

## Warranty

- 5 years for product
- 10 years on 90% for performance
- 25 years on 80% for performance

## Recommended Applications

- Residential roof top systems
- On-grid commercial systems
- On-grid utility systems
- Off-grid commercial systems
- Off-grid utility systems

Model	BYD 200P6-30	BYD 205P6-30	BYD 210P6-30	BYD 215P6-30	BYD 220P6-30	BYD 225P6-30	BYD 230P6-30	BYD 235P6-30	BYD 240P6-30
Open Circuit Voltage (Voc)	34.20V	34.45V	34.68V	34.93V	35.16V	35.38V	35.56V	35.76V	36.00V
Maximum Operating Voltage (Vmp)	28.5V	28.71V	28.90V	29.11V	29.30V	29.48V	29.63V	29.80V	30.00V
Short Circuit Current (Isc)	7.86A	8.00A	8.14A	8.28A	8.41A	8.44A	8.69A	8.84A	8.96A
Maximum Operating Current (Imp)	7.02A	7.14A	7.27A	7.39A	7.51A	7.54A	7.76A	7.89A	8.00A
Maximum Power at STC (Pmax)	200Wp	205Wp	210Wp	215Wp	220Wp	225Wp	230Wp	235Wp	240Wp
Operating Temperature	-40°C ~ +85°C								
Maximum System Voltage	1000V DC								

■ STC: IRRADIANCE 1000w/m<sup>2</sup> , Module temperature 25°C, AM=1.5



Build your dreams



BYD COMPANY LIMITED

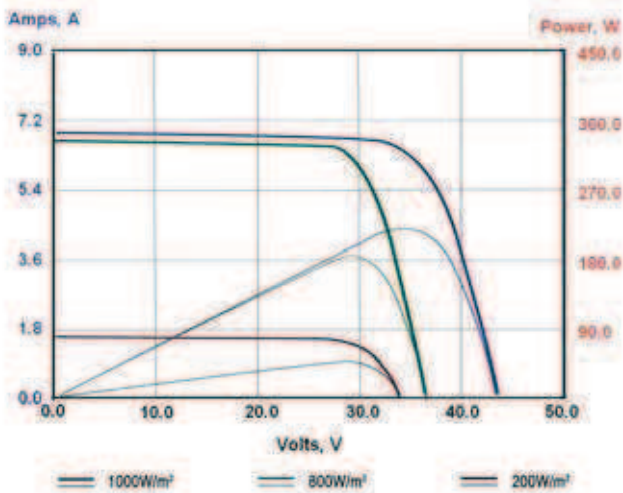
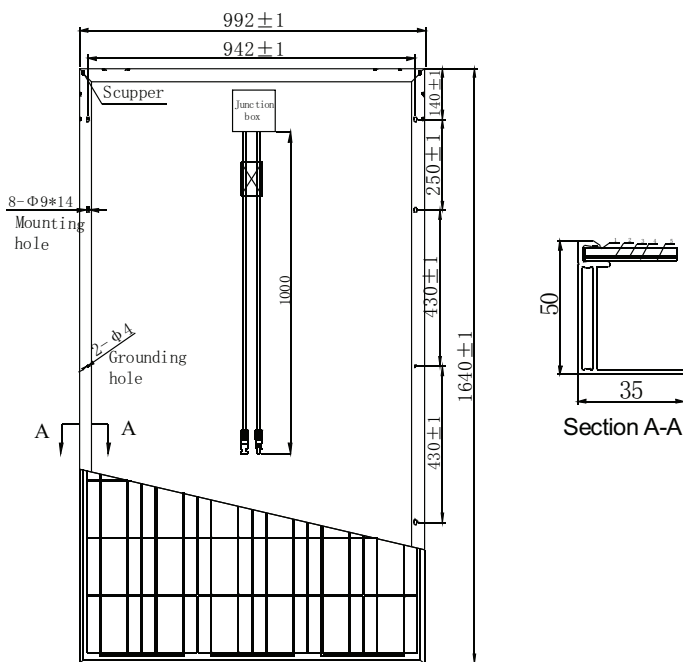

#### Temperature Coefficients

NOCT	45°C ± 2°C
Short-circuit current temperature coefficient	0.045%/°C
Open-circuit voltage temperature coefficient	-0.34%/°C
Peak power temperature coefficient	-0.47%/°C
Power tolerance	± 3%

NOCT:Nominal Operating Cell Temperature. The above data is only for reference.

#### Specifications

Cell	Polycrystalline silicon solar cells 156 × 156 mm/6 inch
No. of cells	60 (6 × 10)
Dimension of module	1640 × 992 × 50 mm/64.6 × 39.1 × 2.0 inch
Weight	20.5 Kg/45.2 lbs
Front Glass	3.2 mm (0.13 inch) tempered glass
Frame	Anodized aluminium alloy
Junction Box	IP65 rated

#### Output Cables

Cable Section Area	4mm <sup>2</sup> /0.0062 Sq in
Cable Length	2 × 1000 mm/ 2 × 39.4 inch

#### Package Information

Package	40' HC
Pcs/pallet	21
Pallet/container	28
Pcs/container	588